

SECTION XVI

EXHIBIT A

1. 2018 Granite Seal Street List
2. 2018 Granite Seal Maps

2018 Granite Seal Base Bid Street List

Subsegment ID	Street*	From*	To*	Pavement Type	Length*(ft)	Width (ft)	SY
07-87-1	NEWMAN	OHIO	S DEAD END	Flexible	628.5	30.0	2,095.0
5.74E+01	KENTON	KLEMP	GRAND AVE	Flexible	386.2	14.0	600.8
05-81-1	JACKSON	SPRUCE	QUINCY	Flexible	1,321.8	21.0	3,084.2
06-100-1	SCOTT	6TH AVE	5TH AVE	Flexible	563.5	24.0	1,502.7
06-96B-1	JAMES	COLUMBIA AVE	BROADWAY	Flexible	364.6	28.0	1,134.3
05-7.1-1	21ST STCT	RANDOLPH	S CULDESAC	Flexible	233.2	31.0	803.2
05-74B-1	KENTON	17TH STTR	E DEAD END	Flexible	120.7	27.0	362.1
06-121A-1	9TH AVE	SPRUCE	OHIO	Flexible	2,633.2	30.0	8,777.3
06-72B-1	PINE	4TH ST	2ND ST	Flexible	886.2	30.0	2,954.0
06-106A-1	PROSPECT	6TH AVE	5TH AVE	Flexible	565.3	30.0	1,884.3
08-132.1-1	ARTHUR	BROADWAY	CLEVELAND TER	Flexible	418.7	18.0	837.4
05-7B-1	21ST ST	KENTON	RANDOLPH	Flexible	282.7	31.0	973.7
06-115-1	CENTRAL AVE	SPRUCE	OHIO	Flexible	2,639.1	27.0	7,917.3
05-85A-1	FRANKLIN	SPRUCE	RANDOLPH	Flexible	657.8	19.0	1,388.7
05-85C-1	FRANKLIN	QUINCY	KANSAS	Flexible	649.5	20.0	1,443.3
06-90D-1	MARSHALL	2ND AVE	5TH AVE	Flexible	1,106.1	30.0	3,687.0
05-85D-1	FRANKLIN	KANSAS	OHIO	Flexible	668.6	22.0	1,634.4
05-5-1	21ST STTR	RANDOLPH	S CULDESAC	Flexible	232.4	31.0	800.5
06-121B-1	9TH AVE	OHIO	PENNSYLVANIA	Flexible	853.1	30.0	2,843.7
06-147A-1	6TH AVE	SPRUCE	MARSHALL	Flexible	929.7	30.0	3,099.0
06-84-1	ARCH	2ND AVE	ESPLANADE	Flexible	1,919.5	30.0	6,398.3
05-224-1	EDGEWOOD CT	WOODRIDGE CT	E CULDESAC	Flexible	424.3	24.0	1,131.5
05-91C-1	KLEMP	QUINCY	KANSAS	Flexible	664.0	30.0	2,213.3
08-195B-1	WILSON AVE	VILAS	LIMIT	Flexible	654.2	27.0	1,962.6
07-164B-1	HOLMAN	14TH ST	10TH AVE	Flexible	2,652.6	27.0	7,957.8
06-181D-1	ROSE ST	MARION ST	EVERGREEN ST	Flexible	459.6	27.5	1,404.3
08-161E-1	4TH AVE	EVERGREEN	S DEAD END	Flexible	1,342.8	29.0	4,326.8
07-39A-1	S 16TH ST	995FT N OF SANTA FE	THORNTON	Flexible	322.1	23.0	823.1
7-226-1	S 24TH ST	N DEAD END	HEBBELN DR	Flexible	371.4	29.0	1,196.7
08-158D-1	SANTA FE	4TH ST	E DEAD END	Flexible	427.6	26.0	1,235.3
08-161D-1	4TH AVE	THORNTON	EVERGREEN	Flexible	680.8	23.0	1,739.8
08-160.1-1	SHERIDAN CT	4TH AVE	W CULDESAC	Flexible	331.5	29.0	1,068.2
08-150E-1	MARION	4TH ST	WILSON AVE	Flexible	2,217.6	40.0	9,856.0
07-158E-1	SANTA FE	285FT E OF WESTWOOD	GRAND AVE	Flexible	572.4	26.0	1,653.6
7/19/2001	S 19TH ST	THORNTON	S DEAD END	Flexible	301.7	27.0	905.1
07-162C-1	VILAS	22ND ST	20TH ST	Flexible	2,218.8	22.0	5,423.7
07-130B-1	SOUTH	GRAND AVE	10TH AVE	Flexible	659.2	26.0	1,904.4
08-166A-2	LOGAN	4TH	E DEAD END	Flexible	334.1	23.0	853.8
11-168A-1	LIMIT	22ND ST	20TH ST	Flexible	2,182.0	17.0	4,121.6
08-136D-1	REES	3RD AVE	2ND AVE	Flexible	366.7	26.0	1,059.4
07-25B-1	S 18TH ST	690FT S OF LECOMPTON	THORNTON	Flexible	1,321.7	30.0	4,405.7
10-181-1	ROSE	MCDONALD RD	S CULDESAC	Flexible	331.2	27.0	993.6
10-259A-1	HIGHLAND DR	PARK LN	E CULDESAC	Flexible	1,333.0	27.0	3,999.0
10-273-1	BROADWAY TER	HIGHLAND TER	S DEAD END	Flexible	250.7	29.0	807.8
09-77-1	S 13TH ST	EISENHOWER RD	N CULDESAC	Flexible	2,285.2	60.0	15,234.7
10-104A-1	MEADOW LN	GARLAND ST	GIRARD	Flexible	616.9	27.0	1,850.7
10-170B-1	TANGLEWOOD ST	GARLAND ST	E DEAD END	Flexible	138.9	27.0	416.7
09-224-1	CEDAR RIDGE DR	21ST ST	W CULDESAC	Flexible	369.7	24.0	985.9
9-389-1	GETTYSBURG DR	CAVALRY CT	RICHMOND DR	Flexible	306.9	26.0	886.6
9-362-1	GETTYSBURG DR	S DEAD END	CAVALRY CT	Flexible	416.5	26.0	1,203.2
09-178A-1	WILDWOOD	W DEAD END	NEW LAWRENCE RD	Flexible	656.6	27.0	1,969.8

2018 Granite Seal Base Bid Street List (Cont.)

Subsegment ID	Street*	From*	To*	Pavement Type	Length*(ft)	Width (ft)	SY
10-109-1	GIRARD	LEWIS DR	N CULDESAC	Flexible	275.3	27.0	825.9
10-188A-1	IDAHO	IOWA	HUGHES RD	Flexible	815.7	27.0	2,447.1
9-373-1	GRAND AV	WALLIS LN	GRAND CT	Flexible	698.1	28.0	2,171.9
10-179A-1	IOWA	N DEAD END	300FT S OF IDAHO	Flexible	1,362.8	21.0	3,179.9
09-55-1	REMINGTON CT	REMINGTON LN	E CULDESAC	Flexible	272.7	27.0	818.1
10-106b-1	BROADWAY TER	N CULDESAC	VILLAGE ST	Flexible	523.3	27.0	1,569.9
10-246-4	LEWIS DR	10TH AVE	E DEAD END	Flexible	998.3	27.0	2,994.9
10-117A-1	SPRING GARDEN A	LIMIT	MEADOW LN	Flexible	1,127.3	27.0	3,381.9
10-171-1	LAKEVIEW CIR	OREGON	LAKEVIEW DR	Flexible	2,878.9	27.0	8,636.7
9-357-1	IRONWOOD DR	WALLIS LN	130FT S OF WALLIS LN	Flexible	129.3	26.0	373.5
10-256-1	HOMESTEAD	GARLAND AVE	W DEAD END	Flexible	224.8	27.0	674.4
10-179D-1	IOWA	S DEAD END	N DEAD END	Flexible	631.7	27.0	1,895.1
09-306-1	MAGNOLIA DR	RICHMOND DR	COUNTY 5	Flexible	1,516.4	24.0	4,043.7
10-170A-1	TANGLEWOOD ST	GIRARD	SPRING GARDEN AV	Flexible	355.9	27.0	1,067.7
08-191c-1	2ND ST	LIMIT	SHERIDAN	Flexible	994.3	27.0	2,982.9
09-209-1	CRESTVIEW	NEWMAN	S DEAD END	Flexible	295.0	27.0	885.0
10-281-1	CEDAR CT	HUGHES RD	W CULDESAC	Flexible	340.9	25.0	946.9
09-310-1	MICHALS	CLAYTON DR	155FT W OF RICHMO	Flexible	940.2	22.0	2,298.3
10-167-4	LAKEVIEW TER	LAKEVIEW CIR	N CULDESAC	Flexible	197.4	27.0	592.2
10-179B-1	IOWA	300FT S OF IDAHO	OREGON ST	Rigid	364.4	29.0	1,174.2

2018 Granite Seal Alternate Bid Street List

Subsegment ID	Street*	From*	To*	Pavement Type	Length*(ft)	Width (ft)	SY
06-173A-1	5TH ST	SPRUCE	LINN	Flexible	2,089.8	30.0	6,966.0
05-75C-1	WASHINGTON	QUINCY	OHIO	Flexible	1,319.5	22.0	3,225.4
06-165A-1	3RD AVE	SPRUCE	MIDDLE	Flexible	1,518.2	30.0	5,060.7
06-104A-1	KANSAS	10TH AVE	CENTRAL AVE	Flexible	790.0	30.0	2,633.3
08-125C-1	GARLAND AVE	THORNTON	250FT S OF MARION	Flexible	576.8	21.0	1,345.9
9-384-1	BRANCHES WAY	COTTONWOOD ST	EISENHOWER RD	Flexible	809.7	40.0	3,598.7
09-333-1	21ST ST	HEATHER CT	N CULDESAC	Flexible	1,263.4	24.0	3,369.1
9-362-1	GETTYSBURG DR	S DEAD END	CAVALRY CT	Flexible	416.5	26.0	1,203.2
09-303-1	FOXHILL	WILDWOOD	S CULDESAC	Flexible	264.0	27.0	792.0
05-86A-1	IRONMOULDERS	FRANKLIN	GRAND AVE	Flexible	864.1	30.0	2,880.3
06-98B-1	MIDDLE	3RD AVE	2ND AVE	Flexible	368.0	29.0	1,185.8
05-82A-1	RANDOLPH	21ST ST	22ND STCT	Flexible	560.3	31.0	1,929.9
05-1.1-1	22ND STCT	RANDOLPH	S CULDESAC	Flexible	187.2	31.0	644.8
06-108A-1	LINN	2ND AVE	4TH ST	Flexible	1,052.2	30.0	3,507.3
06-129b-1	COLUMBIA AV	FRANK	JAMES	Flexible	930.9	30.0	3,103.0
07-128-1	CANTERBURY CT	N CULDESAC	RIDGE RD	Flexible	525.4	27.0	1,576.2
08-127-1	MONTEZUMA AVE	REES	THORNTON	Flexible	918.1	24.0	2,448.3
07-130A-1	SOUTH	KLEMP	GRAND AVE	Flexible	321.4	18.0	642.8
07-97D-1	GRAND AVE	VILAS	MARION	Flexible	1,561.3	31.0	5,377.8
08-152D-1	EVERGREEN	1ST ST	E DEAD END	Flexible	284.1	27.0	852.3
8-208-1	LIMIT ST	HOME PLACE	E CULDESAC	Flexible	464.6	26.0	1,342.2
07-39C-1	S 16TH ST	330FT N OF SANTA FE	720FT N OF SANTA FE	Flexible	393.4	19.0	830.5
10-143-1B	GODDARD CIR INT	VIRGINIA CIR	GODDARD CIR	Flexible	89.6	18.0	179.2
10-226-1A	PARK TEN CT	W END	E END	Flexible	394.3	46.0	2,015.3
09-302.2-1	GATEWOOD	630 FT E OF NEW LAWRENCE	10TH AVE	Flexible	1,465.0	22.0	3,581.1
10-226-1	PARK TEN CT	PARK AVE	PARK TEN CT	Flexible	328.2	27.0	984.6
10-145-1F	GODDARD CIR INT	GODDARD CIR	GODDARD CIR	Flexible	106.0	18.0	212.0

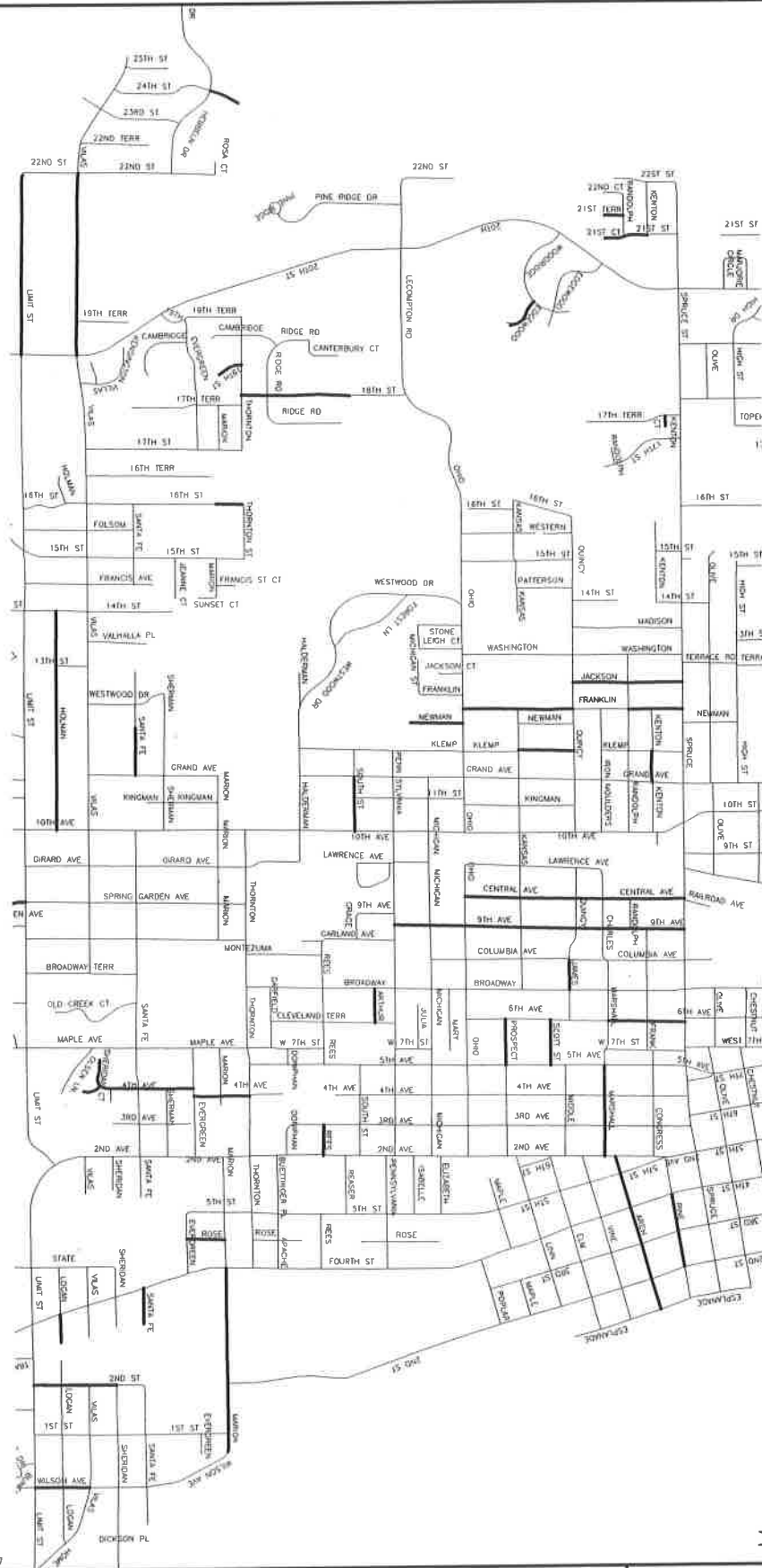

3/14/2018
 T:\17-0521-02\PROJECT\C3D\GRANITE SEAL\PLANS.dwg

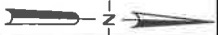

8900 Indian Creek Parkway, Suite 450
 Overland Park, Kansas 66210
 Phone: 913-239-1100

Toll Free: 877-527-5468
 Fax: 913-239-1111
 www.affinis.us

CITY OF LEAVENWORTH, KS
 PAVEMENT MANAGEMENT PROGRAM

2018 Granite Seal

Date:
 Drawn By: JLF
 Checked By: RPS
 Approved By: KEL
 File:
 Job #17-0521.0200

1

1 OF 4

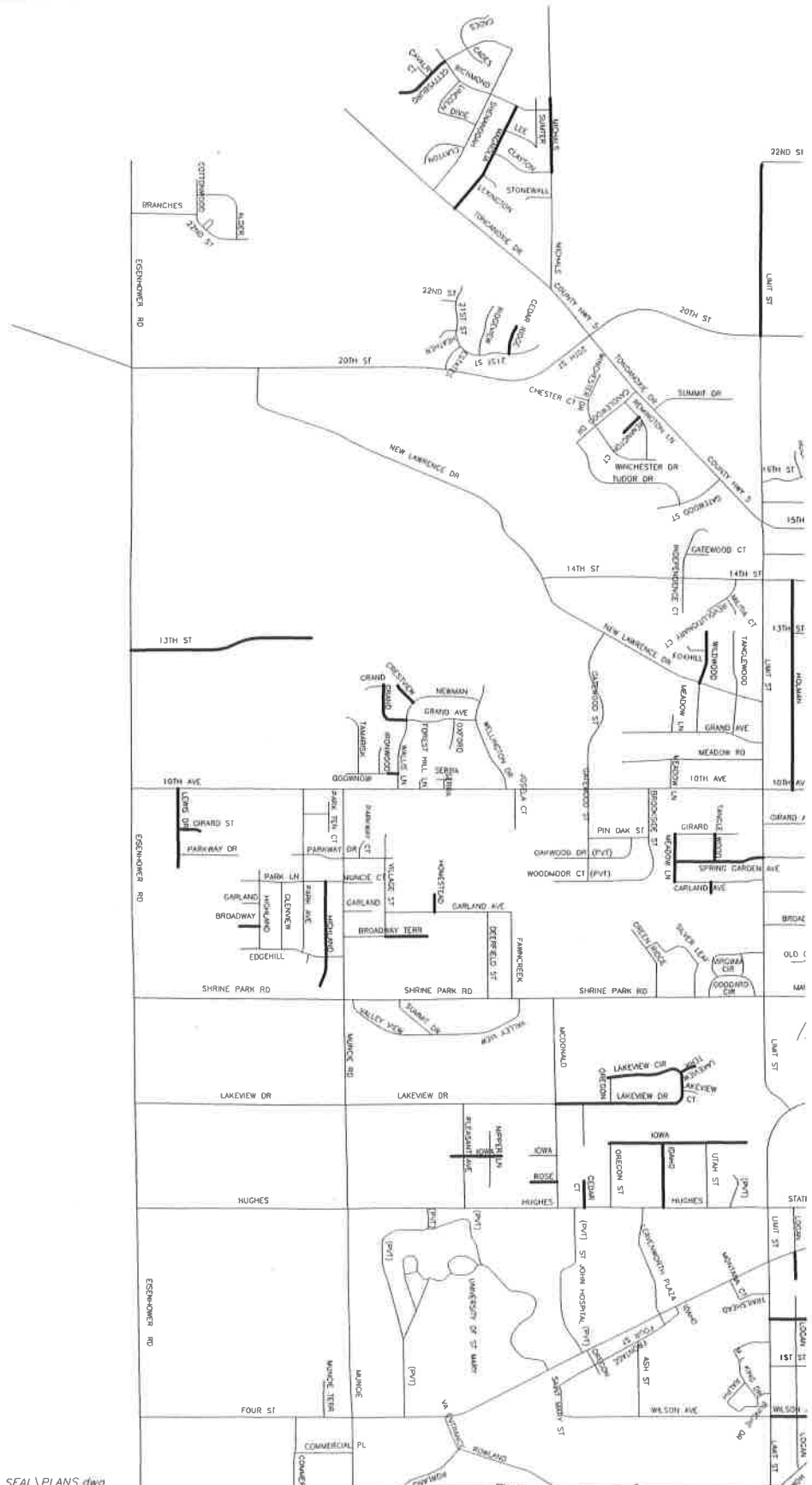

3/14/2018
 T:\17-0521-02\PROJECT\C3D\GRANITE SEAL\PLANS.dwg



8900 Indian Creek Parkway, Suite 450
 Overland Park, Kansas 66210
 Phone: 913-239-1100
 Toll Free: 877-527-5468
 Fax: 913-239-1111
 www.affinis.us

**CITY OF LEAVENWORTH, KS
 PAVEMENT MANAGEMENT PROGRAM**

2018 Granite Seal

Date:
 Drawn By: JLF
 Checked By: RPS
 Approved By: KEL
 File:
 Job #17-0521.0200

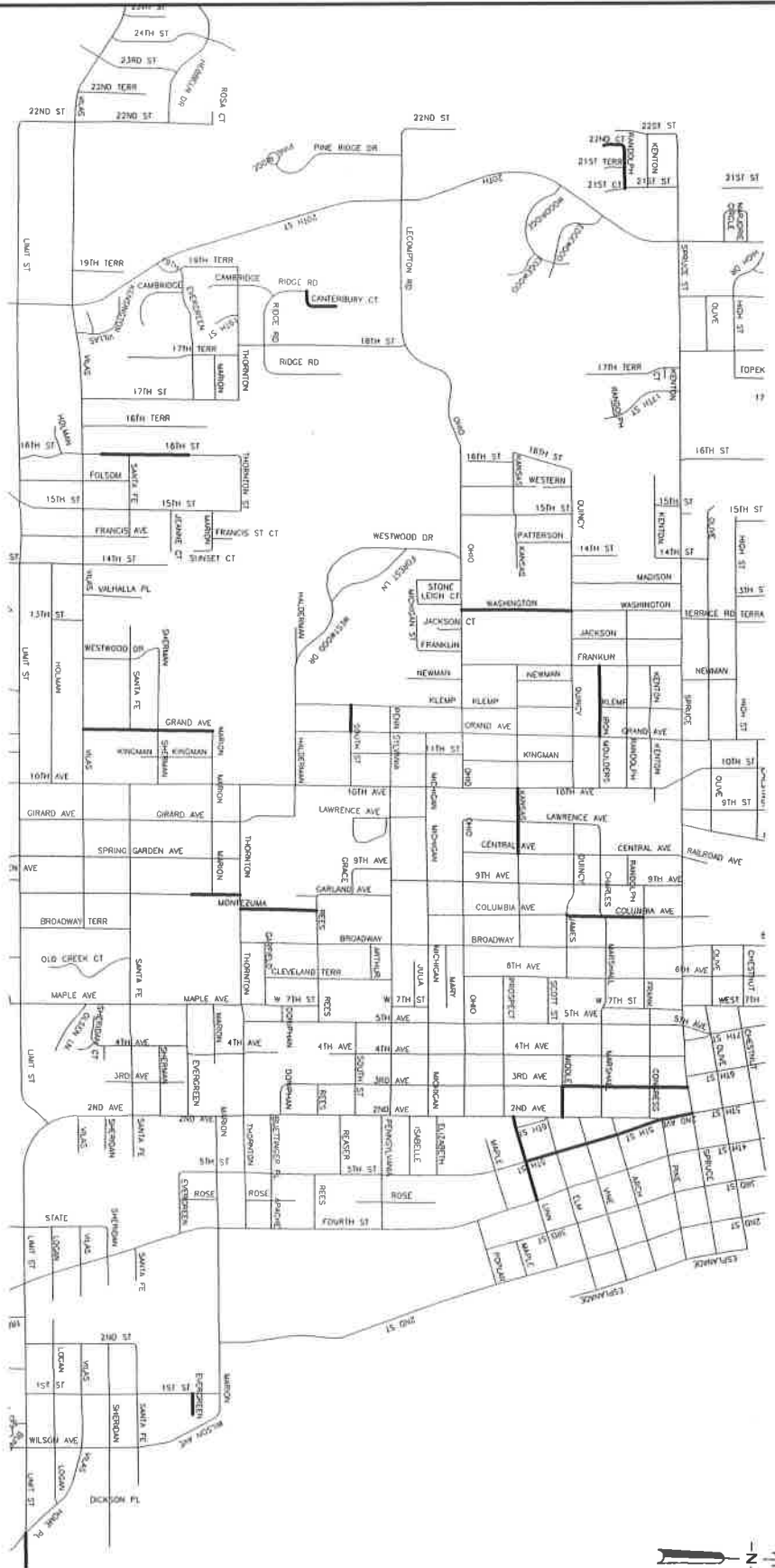

3/14/2018
 T:\17-0521-02\PROJECT\C3D\GRANITE SEAL\PLANS - ALTERNATE.dwg



8900 Indian Creek Parkway, Suite 450
 Overland Park, Kansas 66210
 Phone: 913-239-1100

Toll Free: 877-527-5468
 Fax: 913-239-1111
 www.affinis.us

CITY OF LEAVENWORTH, KS
 PAVEMENT MANAGEMENT PROGRAM

2018 Granite Seal - Alternate

Date:
 Drawn By: JLF
 Checked By: RPS
 Approved By: KEL
 File:
 Job # 17-0521.0200

3

3 OF 4

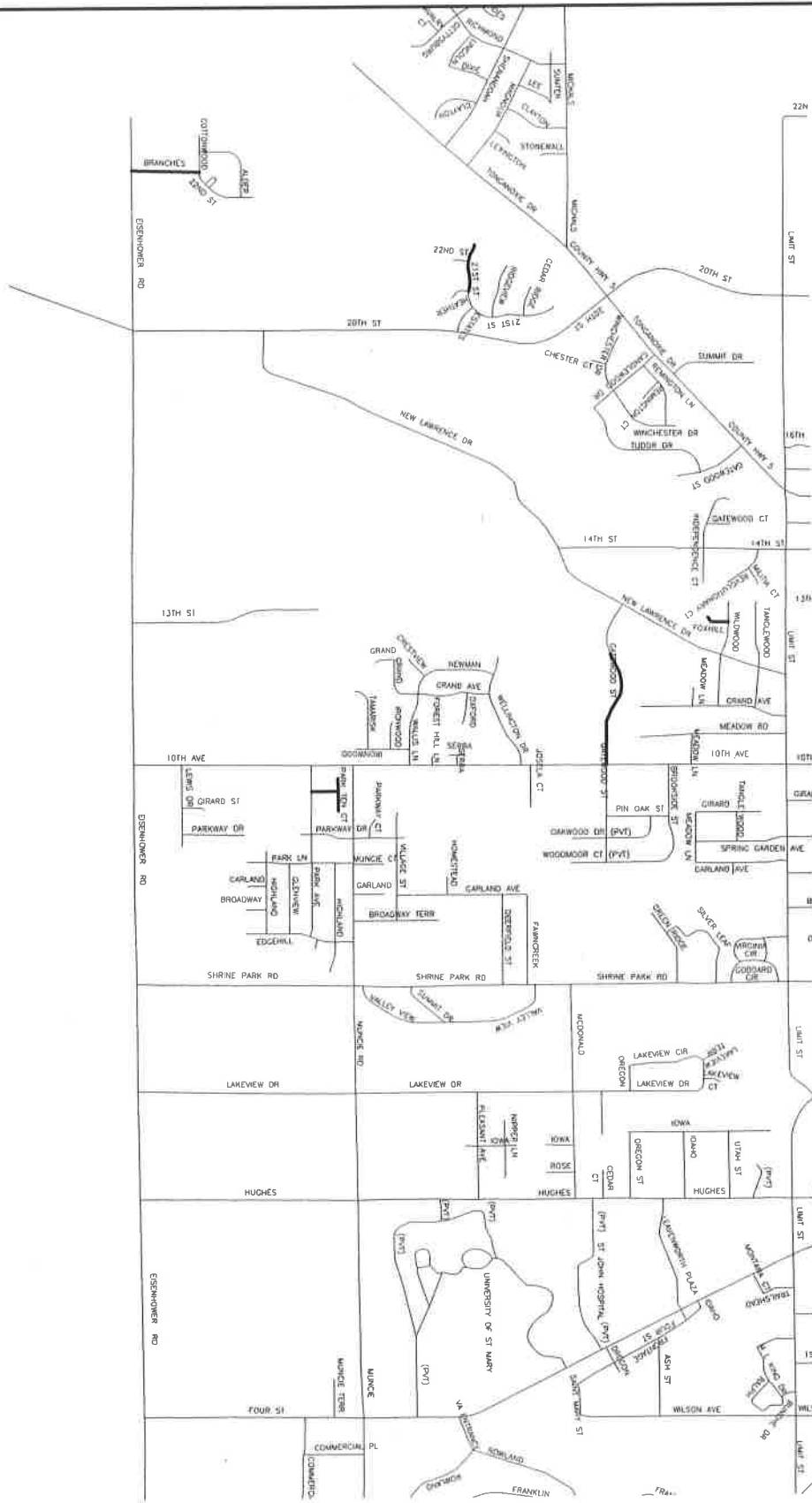

3/14/2018
 T:\17-0521-02\PROJECT\C3D\GRANITE SEAL\PLANS - ALTERNATE.dwg

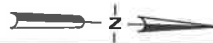

Affinis
 corp

8900 Indian Creek Parkway, Suite 450
 Overland Park, Kansas 66210
 Phone: 913-239-1100

Toll Free: 877-527-5466
 Fax: 913-239-1111
 www.affinis.us

**CITY OF LEAVENWORTH, KS
 PAVEMENT MANAGEMENT PROGRAM**

2018 Granite Seal - Alternate

Date:
 Drawn By: JLF
 Checked By: RPS
 Approved By: KEL

File:
 Job # 17-0521.0200

4

4 OF 4